

FOR LEASE – BUILD TO SUIT

PRIME RETAIL CORNER LOCATION
1200 Central Avenue (Sutherland)

enzogroup.com



sales

leasing

property & asset
management

consulting

marketing

tenant
representation



ADDRESS	1200 Central Ave – Corner of Central Ave & 112 th St E
LOCATION	Sutherland (North East Section of Saskatoon)
ZONING	B5A
LOT SIZE	15,967 sf (0.367 acre)
SITE DETAILS	Prime Retail Corner – Located on Central Avenue (major artery) – Site service area is Sutherland, Forest Grove, College Park, Silverspring, Erindale and Willowgrove – 12692 daily traffic volume exposure
POTENTIAL CRUs	1,200 sf up to 8,000
POSSESSION	Spring 2013 (estimated)
NET LEASE RATE	\$25.00 psf
OCCUPANCY COSTS	\$5.50 psf (estimated)

enzogroup realty corp.
6 – 129 2nd Avenue N
Saskatoon, SK
S7K 2A9

T 306.668.3606
F 306.668.3672

email: info@enzogroup.com

enzogroup.com

for viewing or for further
information please call

Gaby Akl
306.241.2486
gaby.akl@enzogroup.com

Commercial
Real Estate
Solutions

enzogroup
REALTY CORP.

FOR LEASE - BUILD TO SUIT

1200 Central Ave

enzogroup.com



sales

leasing

property & asset
management

consulting

marketing

tenant
representation

SITE PLAN – OPTION A

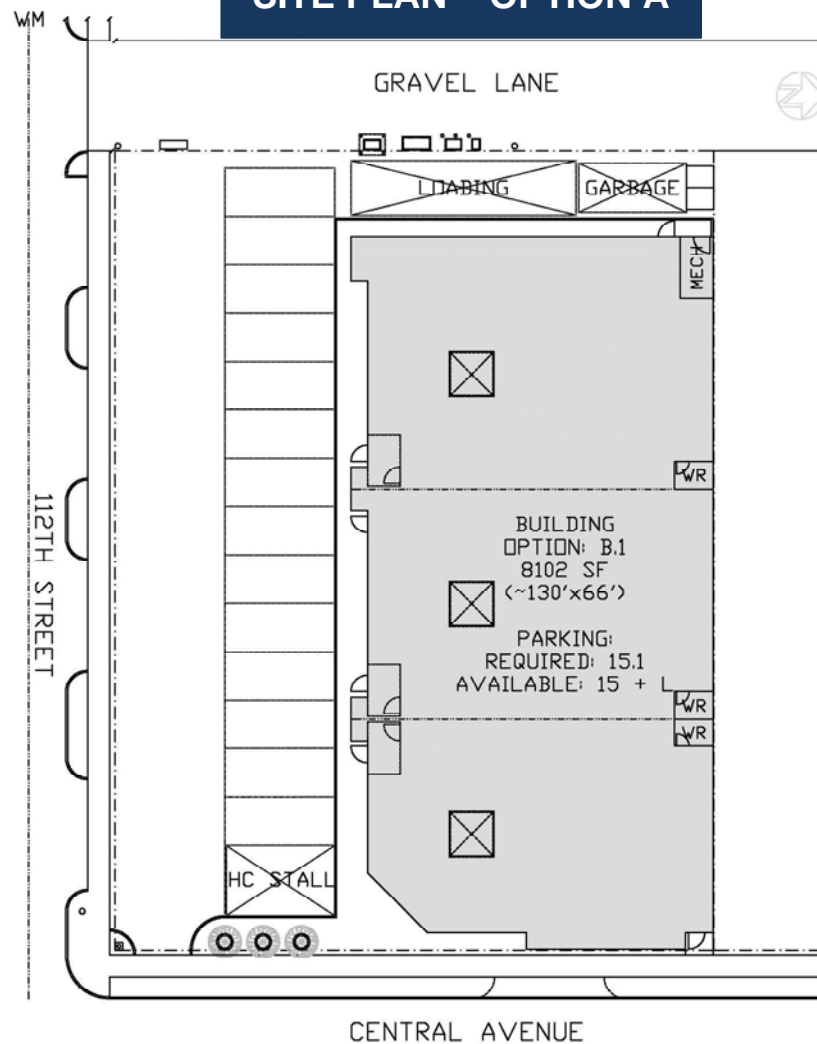

enzogroup realty corp.
6 – 129 2nd Avenue N
Saskatoon, SK
S7K 2A9

T 306.668.3606
F 306.668.3672

email: info@enzogroup.com

enzogroup.com

*for viewing or for further
information please call*

Gaby Akl
306.241.2486

gaby.akl@enzogroup.com

Commercial
Real Estate
Solutions

enzogroup
REALTY CORP.

FOR LEASE - BUILD TO SUIT

1200 Central Ave

enzogroup.com



sales

leasing

property & asset
management

consulting

marketing

tenant
representation

SITE PLAN – OPTION B

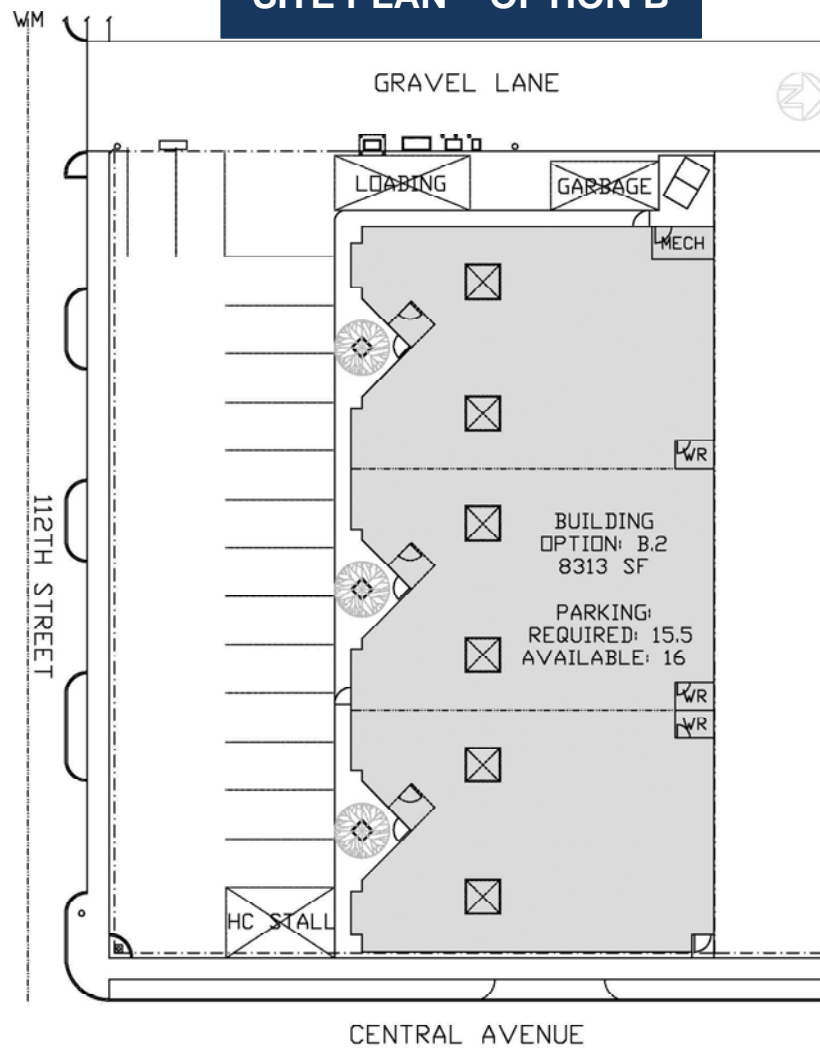

enzogroup realty corp.
6 – 129 2nd Avenue N
Saskatoon, SK
S7K 2A9

T 306.668.3606
F 306.668.3672

email: info@enzogroup.com

enzogroup.com

*for viewing or for further
information please call*

Gaby Akl
306.241.2486

gaby.akl@enzogroup.com

Commercial
Real Estate
Solutions

enzogroup
REALTY CORP.

FOR LEASE - BUILD TO SUIT

1200 Central Ave

enzogroup.com



sales

leasing

property & asset
management

consulting

marketing

tenant
representation

SITE PLAN – OPTION C

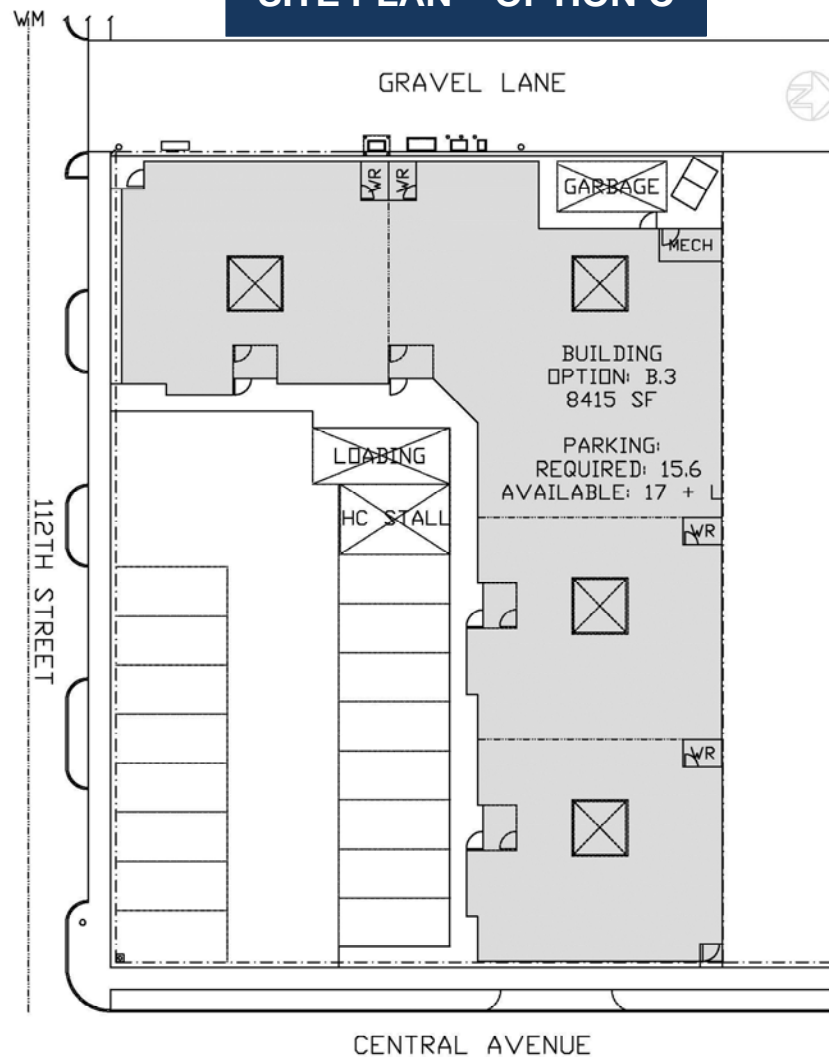

enzogroup realty corp.
6 – 129 2nd Avenue N
Saskatoon, SK
S7K 2A9

T 306.668.3606
F 306.668.3672

email: info@enzogroup.com

enzogroup.com

*for viewing or for further
information please call*

Gaby Akl
306.241.2486

gaby.akl@enzogroup.com

Commercial
Real Estate
Solutions

enzogroup
REALTY CORP.

FOR LEASE – BUILD TO SUIT

PRIME RETAIL CORNER LOCATION

1200 Central Avenue (Sutherland)

enzogroup.com



sales

leasing

property & asset
management

consulting

marketing

tenant
representation

SUBJECT PROPERTY

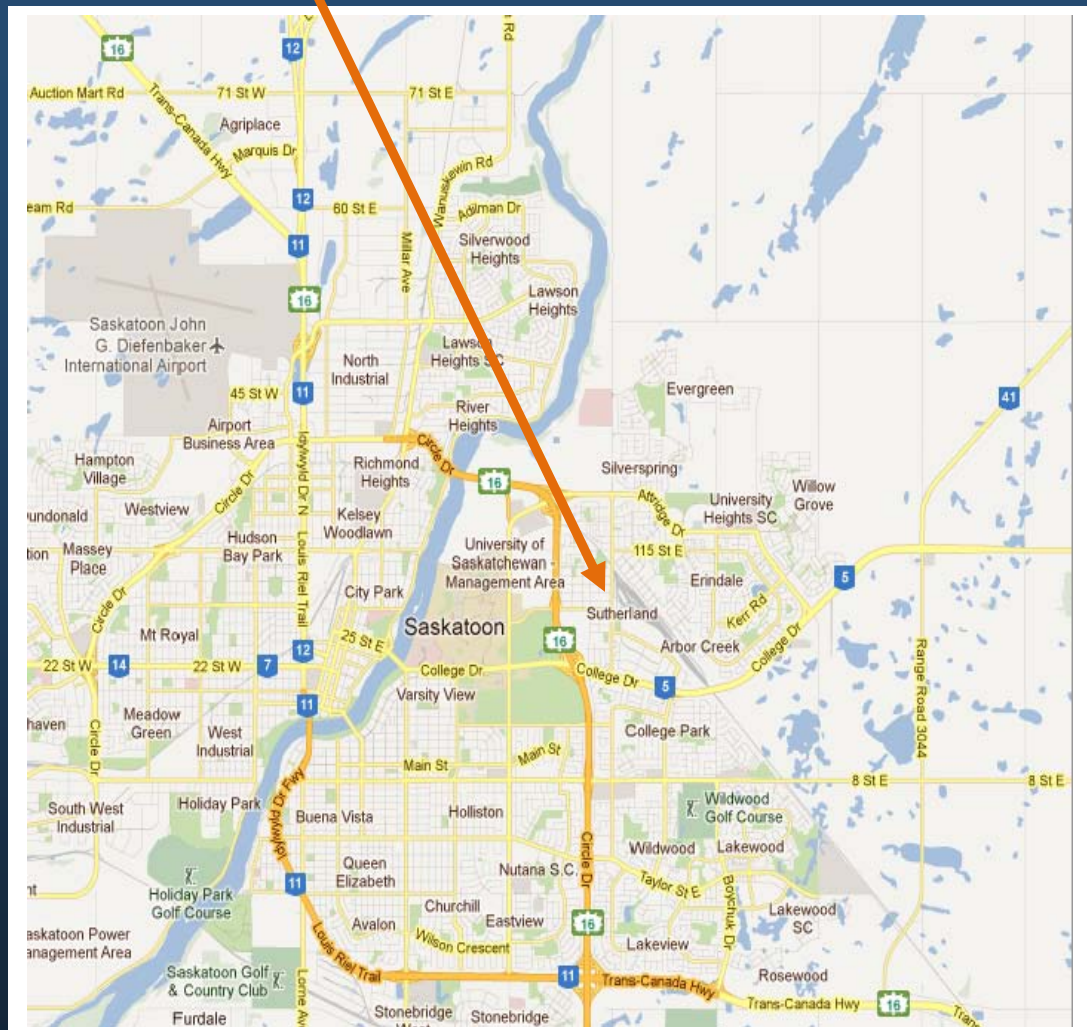

enzogroup realty corp.
6 – 129 2nd Avenue N
Saskatoon, SK
S7K 2A9

T 306.668.3606
F 306.668.3672

email: info@enzogroup.com

enzogroup.com

*for viewing or for further
information please call*

Gaby Akl
306.241.2486
gaby.akl@enzogroup.com